

The Peoria Civic Center has been the home for live entertainment in Central Illinois since opening in 1982, and is the largest convention facility in downstate Illinois.

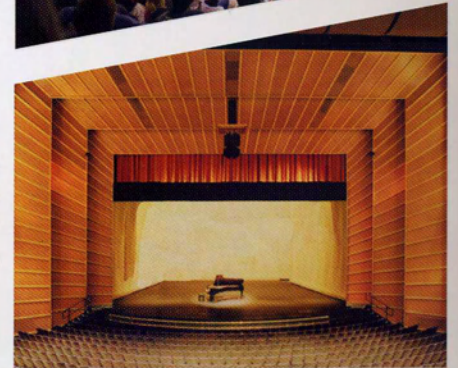
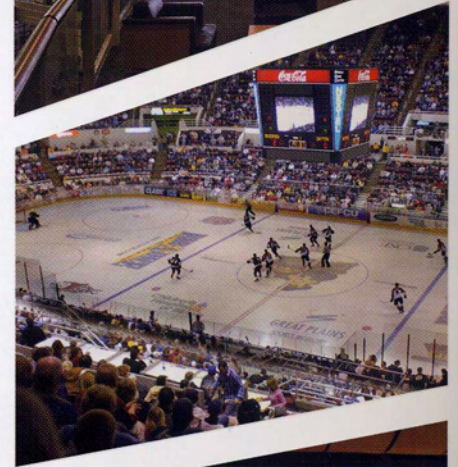
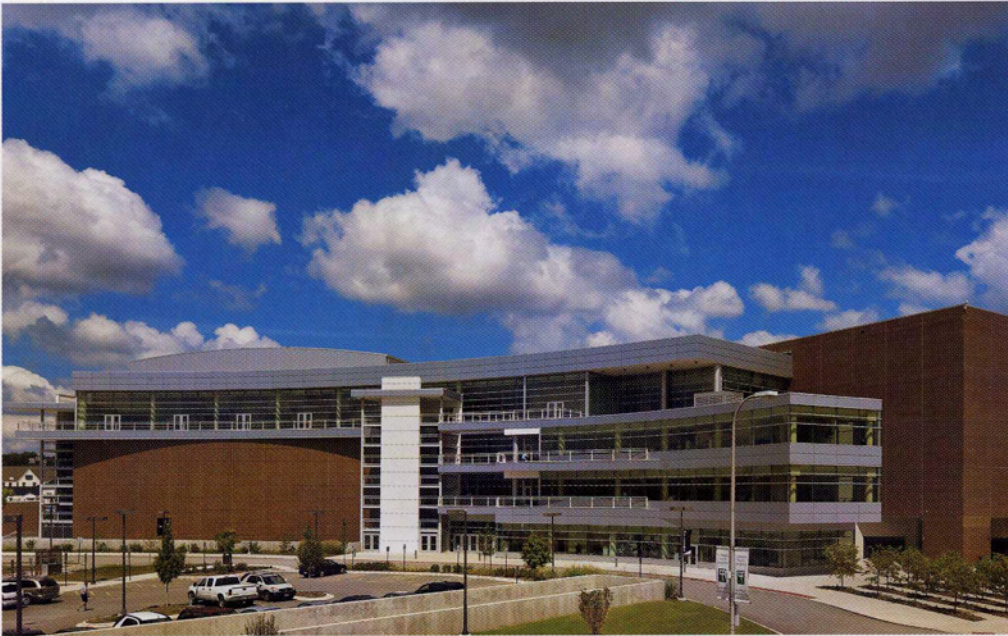

GREAT SERVICE, GREAT VALUE

Since 1982, the Peoria Civic Center has been hosting conventions, meetings, consumer shows, and events. Over 600 event days a year equates to experience you can count on. Our repeat business is a testament to the high level of customer care the staff provides for each and every client. Combine a midwestern touch of hospitality with facility values that are down to earth, and the Peoria Civic Center is a smart choice for event planners.

Where

The Peoria Civic Center is an SMG managed facility located in downtown Peoria, in Central Illinois. It is situated in a beautiful valley called "Illinois River Country" and is less than a three hour drive from Chicago and St. Louis. The General Wayne A. Downing Peoria International Airport offers daily jet service to many US hubs and is undergoing an extensive renovation.

What

In 2007 a \$55 million expansion and upgrade expanded the Peoria Civic Center exhibit hall space to 110,000 sq. ft. of continuous space with 10 new covered docks. A beautiful 27,000 sq. ft. ballroom was also added along with 12,000 sq. ft. of prefunction space. The 12,000 seat arena added concessions stands and expanded restroom facilities. This versatile facility also houses a 2,200 theater and 16 additional breakout rooms.

EXHIBIT HALLS

The Peoria Civic Center is the largest exhibition facility in downstate Illinois. The 110,000 square foot Exhibit Hall is the size of two football fields and can be divided into four halls with a ceiling height of 30 feet to the beams. In addition, there is an experienced staff capable of handling everything from technical services to catering.

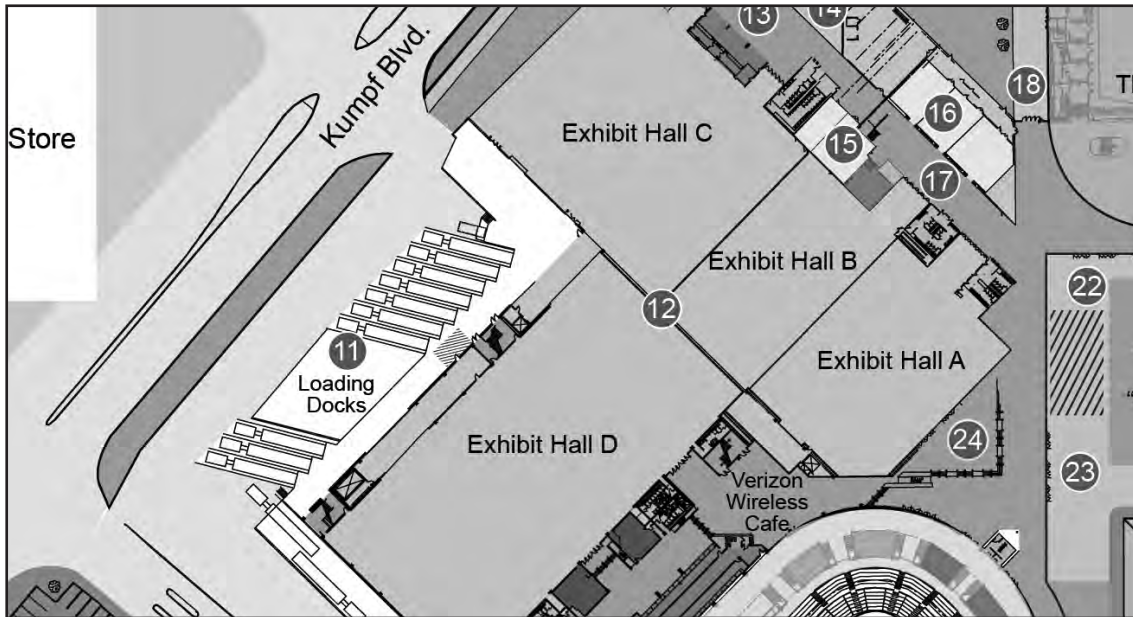

Room	Floor Space	Booth Space	Theater Capacity	Banquet Capacity	Classroom Capacity
Exhibit Hall A	18,681 sq. ft. (118 6 x 157 8)	107 10 x10 Booths	2,125 people	1,240 people	1,235 people
Exhibit Hall B	13,953 sq. ft. (88 x 157 8)	84 10 x10 Booths	1,585 people	912 people	920 people
Exhibit Hall C	31,034 sq. ft. (196 8 x 157 8)	189 10 x10 Booths	3,555 people	2,000 people	2,046 people
Exhibit Hall D	45,000 sq. ft. (300 x 150)	273 10 x10 Booths	5,140 people	2,912 people	2,966 people
Exhibit Halls A&B	32,634 sq. ft. (207 x 157 8)	191 10 x10 Booths	3,710 people	2,152 people	2,155 people
Exhibit Halls B&C	44,987 sq. ft. (284 x 157 8)	273 10 x10 Booths	5,140 people	2,912 people	2,966 people
Exhibit Halls A-C	63,668 sq. ft. (403 x 157 8)	380 10 x10 Booths	7,265 people	4,000 people	4,200 people
Exhibit Halls B, C, D	89,987 sq. ft.	546 10 x10 Booths	10,280 people	5,824 people	5,932 people
Exhibit Halls A-D	108,668 sq. ft.	653 10 x10 Booths	12,405 people	6,912 people	7,166 people

EXHIBIT HALLS

Floor Space

Available space features concrete floors with unlimited load capacity in Halls A, B, and D and with limited restricted areas in Hall C. Halls A, B, and C are column free with only three columns in Hall D placed within the 30 ft. grid.

Utilities

In-floor electric, water, drain, telephone on a 30 grid with 120/208 volts in the floor every 30 feet and wireless high speed internet connections, 11 MB/sec.

Energy

All rental rates include energy, basic janitorial services and one event coordinator for eight consecutive hours. Additional hours are billed at current rates. Ventilation and room temperature controls are available.

Loading Docks

Ten loading docks, with three closed and seven covered, are located off Exhibit Hall D. Two additional docks are located off the Terrazzo lobby. Access is available from Monroe St. One additional drive-in door (24 by 24) is located in Hall C.

Registration Area

Exhibit Hall C features a 638 sq. ft. lockable built-in registration area with counters and three windows. Located directly behind this area is a 10 x 10 Manager s office.

Business & Conference Center

Located off Hall B and offering a variety of business services for convention, conference and trade show attendees. Services available include telephone, fax, copier, computer access and a 12 person conference room.

Acoustical Treatment

Walls have been treated with Tectum for sound control.

Catering / Concessions

Services are available through Centerplate, our exclusive in-house food service. Halls A, B, and C feature concession stands, which are also handled by Centerplate.

Staffing

Peoria Civic Center event managers can schedule ticket takers, sellers, ushers and other staff.

Audio Visual

The Exhibit Halls feature zone control and a multi-speaker PA system. Your complete audio visual equipment needs, including an AV specialist, are available. Please ask for pricing details. Outside vendors are allowed with Peoria Civic Center approval.

Move-in and Move-out

Peoria Civic Center has forklifts and operators on hand. Please ask your event coordinator for a quote.

Security & Emergency

Peoria Civic Center provides full service security, which is arranged through your event coordinator. A certified nurse is required with events hosting 300 people or more.

Decorator/Shipping

Decorator services are provided by the client with Peoria Civic Center approval. Pre-shipment and drayage must be held by decorator or outside service.



MEETING ROOMS

The Peoria Civic Center features 17,000 sq. ft. of meeting space in addition to the Ballroom. These 16 rooms are located on the first and second levels and vary in size with seating from 10 - 1,000 people with access available via stairs and elevators.

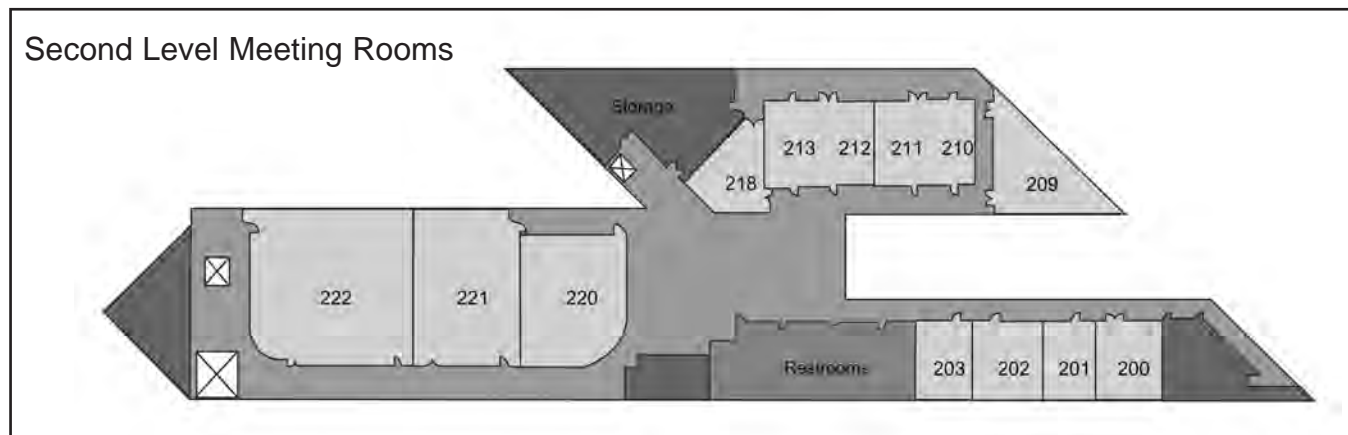
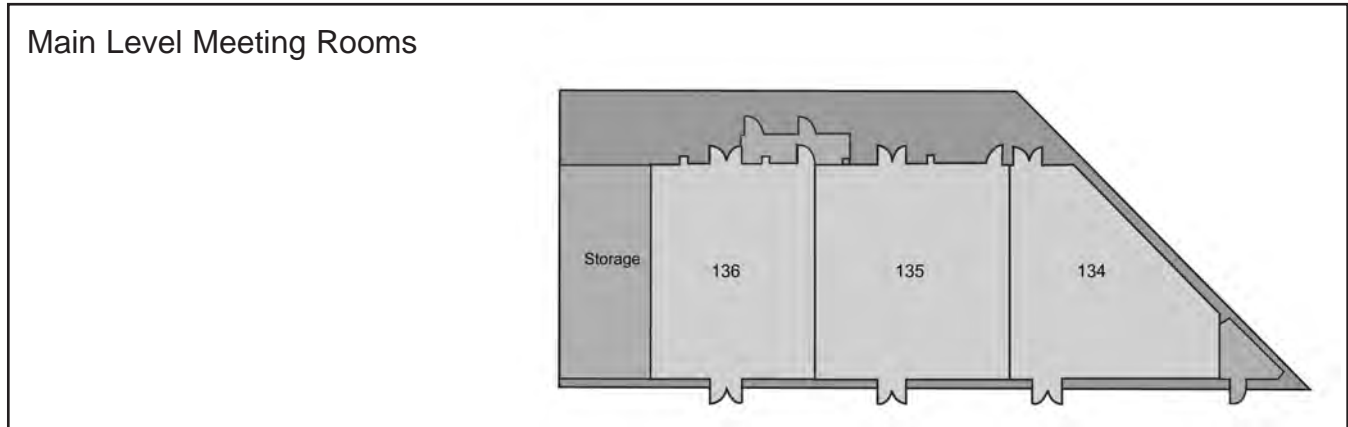

Lobbies

Skylight	3,424 sq. ft.	117 x 30
Triangle	2,383 sq. ft.	101 x 65
Terrazzo	3,932 sq. ft.	42 x 100
220 s Pre-function	1,500 sq. ft.	40 x 44

Audio Visual
Your complete audio visual equipment needs, including an AV specialist, are available. Some meetings rooms have special no glare finish, allowing for images to be projected onto the wall.

Event Services
The experienced Peoria Civic Center staff will coordinate every aspect of your event from decorators to floral services. All events can be turnkey. You are also allowed to bring in your preferred suppliers, with Peoria Civic Center approval.

Security/ Emergency
The Peoria Civic Center provides full-service security that is arranged through your event manager. A certified nurse is required with events hosting 300 people or more.

Catering
Exclusive catering provided by Centerplate, our in-house caterer. Room rental rates may be reduced or waived depending on the amount of food and beverage purchased through Centerplate.

Internet Access
We feature high-speed wireless Internet, Video Streaming, and Video Conferencing throughout our facilities.

Restrooms
Restrooms are conveniently located throughout the facilities.



MEETING ROOMS

Room	Floor Space	Width & Length	Height	Theater Capacity	Banquet Capacity	Classroom Capacity
134	1,200 sq. ft.	Triangular	14	126 people	72 people	90 people
135	1,500 sq. ft.	40 x 37 6	14	153 people	96 people	112 people
136	1,160 sq. ft.	40 x 29	14	110 people	64 people	70 people
135/136	2,660 sq. ft.	40 x 66 6	14	263 people	160 people	182 people

Room	Floor Space	Width & Length	Height	Theater Capacity	Banquet Capacity	Classroom Capacity
200	600 sq. ft.	25 x 24	9	63 people	40 people	45 people
201	490 sq. ft.	25 x 19 6	9	63 people	40 people	36 people
202	530 sq. ft.	20 x 26 6	9	54 people	32 people	38 people
203	525 sq. ft.	25 x 21	9	54 people	40 people	40 people
209	929 sq. ft.	Triangular	10	90 people	56 people	70 people
210	608 sq. ft.	32 x 19	10	63 people	48 people	46 people
211	608 sq. ft.	32 x 19	10	63 people	48 people	46 people
210/211	1,216 sq. ft.	32 x 38	10	126 people	96 people	91 people
212	608 sq. ft.	32 x 19	10	63 people	48 people	46 people
213	672 sq. ft.	32 x 21	10	63 people	48 people	51 people
212/213	1,280 sq. ft.	32 x 40	10	126 people	96 people	96 people
218	644 sq. ft.	Triangular	10	45 people	32 people	35 people
220	1,797 sq. ft.	39 8 x 48 6	10	197 people	96 people	99 people
221	2,181 sq. ft.	40 x 56 10	10	256 people	104 people	114 people
222	3,303 sq. ft.	60 7 x 56 10	10	385 people	224 people	204 people
220/221	3,978 sq. ft.	88 6 x 40	10	453 people	192 people	224 people
221/222	5,484 sq. ft.	100 7 x 56 10	10	641 people	320 people	300 people
220-222	7,289 sq. ft.	149 1 x 56 10	10	1,000 people	408 people	417 people

Included with your room rental are tables, chairs, initial room setup, energy, house sound, podium, and wired microphone. When the primary purpose of the event includes food service, basic white linens are also provided.

*Numbers reflect maximum capacity with podium in front of room. Additions will decrease capacities of staging.

BALLROOM/MEETING SPACE

The Ballroom is located on the 4th level of the Peoria Civic Center and available in the Fall of 2007. This high finish room will seat up to 1,600 for a banquet or break into nine separate meeting rooms. The ceiling height varies from 23' to 25' and is easily accessible by stairs, escalators and elevators. The pre-function space features a coat check, green room, and an outdoor balcony offering a panoramic view of downtown Peoria.



Great Hall

Featuring 15,200 sq. ft. of pre-function space, it is attached to the Arena and leads to the Ballroom. It has a ceiling height of 64 ft. and is enclosed by a glass arcade. As you enter this area, you are welcomed by the receptionist and access is available to the Peoria Rivermen Hockey Team offices and store, and Box Office.

Pre-function Space

This area features 12,000 sq. ft. of high finished carpeted space with access to the outdoor balcony and Great Hall, plus two coat check areas and a green room.

Patio Area

Enjoy a chance to go outdoors from the 4th level to the patio area, which is 8 x 130 sq. ft. and located just off the pre-function space.

Access

Accessible off the Great Hall, by escalator or elevators. All Peoria Civic Center facilities are ADA approved.

BALLROOM / MEETING SPACE

Room	Floor Space	Room Dimensions	Theater Capacity	Banquet Capacity	Classroom Capacity
Ballroom	26,550 sq. ft.	127' 6" x 208'	2,880 people	1,550 people	1,656 people
400	11,230 sq. ft.	127' 6" x 88'	1,218 people	680 people	680 people
401-404	7,656 sq. ft.	127' 6" x 60'	793 people	500 people	500 people
405-408	7,656 sq. ft.	127' 6" x 60'	793 people	500 people	500 people
3 sections of 401-408	5,580 sq. ft.	93' x 60'	767 people	400 people	390 people
2 sections of 401-408	3,720 sq. ft.	62' x 60'	510 people	250 people	250 people
1 section of 401-408	1,800 sq. ft.	31' x 60'	252 people	100 people	132 people
400-404	18,900 sq. ft.	127' 6" x 148'	2,150 people	1,180 people	1,180 people
400, 405-408	18,900 sq. ft.	127' 6" x 148'	2,150 people	1,180 people	1,180 people

Ballroom Rental

Included with your room rental are tables, chairs, initial room setup, energy, house sound, and wired microphone. Basic white linens are provided when the room is used for banquets or food functions.

Versatile Space

The Ballroom may be used for a banquet, reception, wedding, meeting(s) or convention. The 27,000 sq. ft. can be divided into nine separate meeting rooms. Please see the chart above for seating details.

Catering

Exclusive catering provided by Centerplate, our in-house caterer. When renting the Ballroom for any food function, rental rates may be reduced or waived depending on the amount of food and beverage purchased through Centerplate before tax and gratuity.

Event Services

The experienced Peoria Civic Center staff will coordinate every aspect of your event from decorators to floral services. All events can be turnkey, or you may use your preferred suppliers with Peoria Civic Center approval.

Internet Access

We feature high-speed wireless Internet, Video Streaming, and Video Conferencing throughout the facility.

Audio Visual

The Peoria Civic Center event staff can arrange for your complete audio visual equipment needs, and provide an AV specialist. Ask your event manager for more information.

Security/ Emergency

The Peoria Civic Center provides full-service security that is arranged through your event coordinator. A certified nurse is required with events hosting 300 people or more.

Access

Accessible off the Great Hall by escalator or elevators. All Peoria Civic Center facilities are ADA approved.

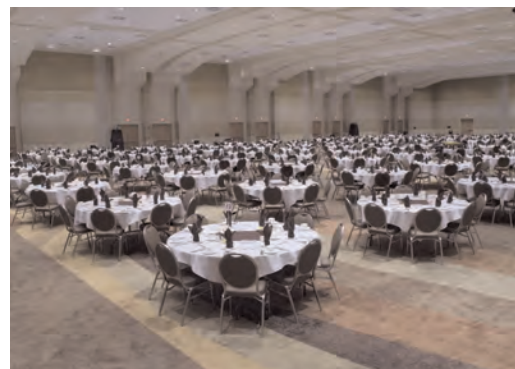

ARENA

Carver Arena at the Peoria Civic Center is the Central Illinois home for major sporting events, big name concerts, and the largest trade shows in the region. Our staff is experienced in making sure every detail is covered, and that each event receives the personal attention it deserves.

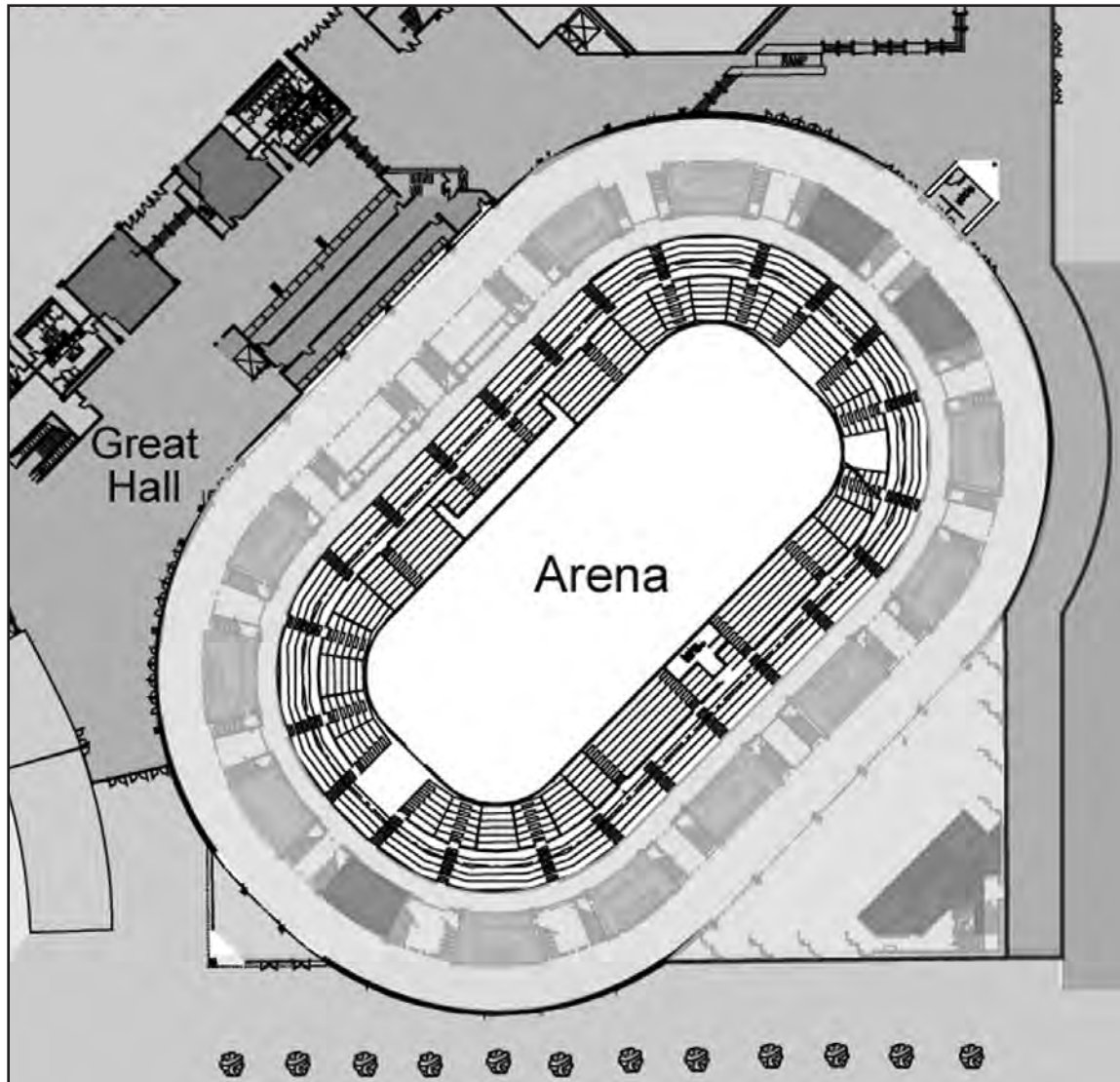

The Peoria Civic Center is the proud home of Bradley Braves Men's Basketball, Peoria Rivermen AHL Hockey, Peoria Pirates AF2 Arena Football, and the IHSA Boys' Basketball State Finals.

"Always been great to work with the Peoria Civic Center staff." - Mike Irwin, IL Kids Wrestling.

"We continue to be very pleased with the Peoria Civic Center and its staff." - Kurt Gibson, IHSA Assistant Executive Director and Boys' Basketball Administrator.



ARENA

Seating

Full Arena seating is 12,036. The maximum capacity available for basketball is 11,433, for hockey 9,919, and for arena football 9,935.

Floor Space

238 x 124 without telescopic risers, curved corners
 200 x 85 with telescopic risers, curved corners
 168 x 80 with full telescopic risers set, square corners
 27,400 sq. ft. floor area
 140 - 10 x 10 booth spaces on the floor
 71 - 10 x 10 booth spaces around outer concourse

Arena Event Rooms

The Event Rooms are located behind Section 2 in the lower arena bowl with a banquet capacity of 370 people.

Rooms	Room Size	Capacity
Main Club Room	2,025 sq. ft.	230
Annex	1,120 sq. ft.	120
Green Room	800 sq. ft.	90
Lexus Club	2,117 sq. ft.	300

(Located on the mezzanine level)

Dressing Rooms

These rooms were renovated in 2006 and consist of one production office, four large team dressing rooms, and four smaller dressing rooms.

Green Room

Located near the current Club Room and Annex, this 800 sq. ft. room includes a full bathroom.

Indoor Loading Facilities

Available for ease of move-in are two 12 x 12 loading doors at floor level, with one 12 x 16 drive-in loading door at floor level, three 5,000 lb. Caterpillar forklifts and one 10,000 lb. capacity Caterpillar forklift.

Concessions

New concession stands featuring state of the art concession areas with service off the Great Hall and Arena, Jefferson Street Concessions also offers new food choices.

Stage Dimensions

Available for rental is Sico Type C Stage in 8 x 8 sections, with a 125 lb. sq. ft. load capacity and an adjustable height of 48 - 72 , and 2,784 sq. ft. (60 x 40 with a 8 x 16 wings).

Scoreboard

Featuring a four-sided video scoreboard with complete in-house support service. Trim height is 47' 6" .

Box Office and Ticket Sales Services

The Peoria Civic Center is a Ticketmaster facility, offering professional box office service.

Energy

All rental rates include energy, basic janitorial services, and one event manager for eight consecutive hours. Additional hours are billed at current rates.

Rigging

Truss height is 76', lateral beams on 30' centers, and 30' curtain can be rigged to split house.

Lighting

Incandescent, variable lighting or mercury vapor options are available. Also available are eight 2,000 watt Xenon Super Trouper Follow Spots.

Audio Visual

A voice and music quality PA system with computer controlled digital signal processing, user configurable distributed overhead speaker system, 20 input mixing console, and an in-house 2 channel clear-com system. Full video services are also available including video streaming and video conferencing.

Internet Access

Featuring High-Speed Wireless, Video Streaming, and Video Conferencing throughout the facility.





PEORIA CIVIC CENTER®

THEATER

The Peoria Civic Center features a state-of-the-art Theater and each season presents a wide array of events including concerts, lectures, family shows, and performances from major Central Illinois Arts Groups. Past performances include Miss Saigon, Phantom of the Opera, Jerry Seinfeld, Itzhak Perlman, and many other international stars.

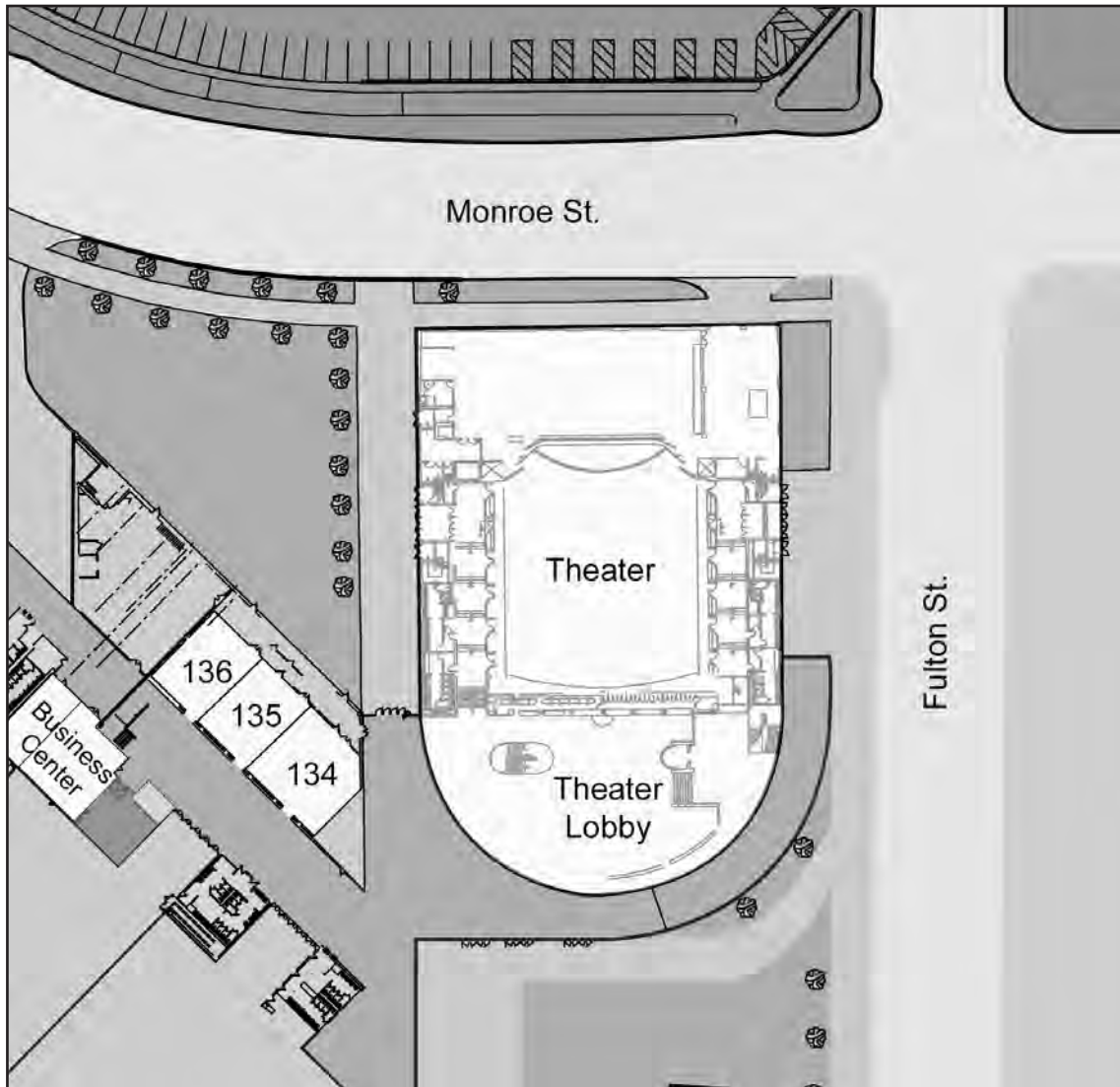

"Well coordinated, competent staff - pleasant to work with. Smoothly planned and good communication. Your facility is very efficiently operated. Our company found it very easy and enjoyable to work with your staff."

- Landis Smith, Producing Director, Brad Simon Organization ("Pinocchio" YouTheater performance)



THEATER

Seating

Full Theater seating is 2,177. The orchestra level is 1,451, the first level balcony is 378 and the second level balcony, including boxes, is 348. The main floor features continental seating and the two balconies have four aisles for easy entrance and exit.

Dressing Rooms

One 1-person star dressing room on stage level Stage Right.

Four 12-person chorus rooms.

Two 8-person dressing rooms.

Two 6-person dressing rooms.

One 3-person dressing room.

All dressing rooms have elevator access Stage Right, and are equipped with a shower, toilet, and make-up mirrors with lights.

Loading Facilities

There are two 12 and 16 drive-in loading doors at stage level and one 8 x 12 hydraulic platform with a weight capacity of 20,000 lbs. One elevator, Stage Right, has a weight capacity of 7,000 lbs.

Stage Dimensions

The following measurements are taken from the upstage of the fire curtain.

Proscenium opening is 50 wide and 26 3 high (high trim of act curtain), Upstage wall is 45 to back wall, Apron edge is 5 6 , Stage Left is 42 2 , Stage Right is 64 , Orchestra Pit is 50 wide and 20 deep with levels at stage, seating and orchestra heights, and the Orchestra shell is 50 wide x 40 deep.

Rehearsal Hall

This hall is located on the third floor and measures 25 x 50 .

Theater Lobby

This dramatic area is open to three levels and two balconies. It is comprised of 7,000 sq. ft. of pre-function space with a capacity of 270 people for a reception or dinner.

Audio Visual

A center speaker cluster, with balcony reinforcement and dressing room paging system is available. A separate, or integrated lobby system, in-house, and 2 channel clear-com systems are available. Listening devices for the hearing impaired and an AV specialist are available.

Internet Access

We feature high-speed wireless Internet, Video Streaming, and Video Conferencing.

Lighting

Three Strong 2K Xenon Super Trouper Follow Spots are available. In addition, a booth is located 114 ft. from plaster line, and there are 144 circuits Front House and 194 circuits in the Stage House proper.

Rigging

There are 46 single-purchase counterweight line sets, with a capacity of 1,200 lbs.

Staffing

Peoria Civic Center event managers can schedule ticket takers, ticket sellers, ushers, and other staff. A Peoria Civic Center certified nurse is required with most events.



LEXUS CLUB



The Lexus Club is located on the mezzanine level of the Peoria Civic Center. This high-finish room is 2,117 square feet featuring lounge seating, a full-service bar, four plasma TVs and private restrooms. The Lexus Club is available to rent when it is not being used for arena events. Catering is available through Centerplate, the Peoria Civic Center's exclusive catering and concession company.

For booking information please phone Jo Stowell (309) 680-3520 or e-mail jstowell@peoriaciviccenter.com. For catering, please contact Sarah McClernon (309) 680-3534 or smcclernon@peoriaciviccenter.com.

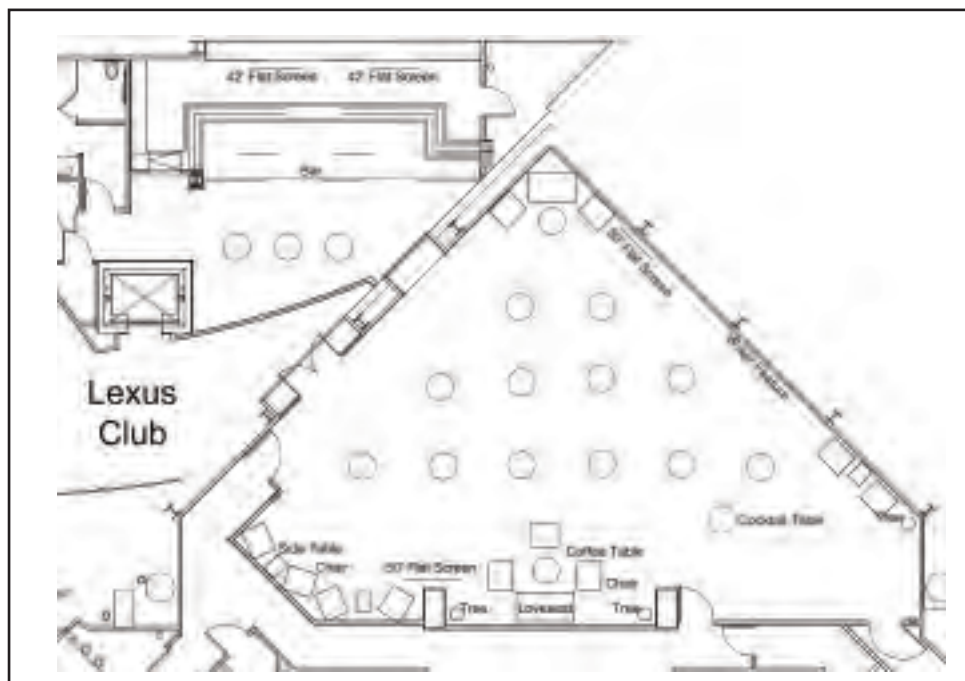

The Lexus Club will host a cocktail reception for up to 250 people with the existing room set up. Included with your room rental are tables, chairs, energy, house sound, and wired microphone. Audiovisual equipment, internet access, and security are available and may be arranged with assistance from your event manager.



Peoria Civic Center
T 309.673.8900 F 309.673.9223
201 SW Jefferson Ave., Peoria, IL 61602
www.PeoriaCivicCenter.com





LEXUS CLUB

The Lexus Club is sponsored by Lexus of Peoria, located at 7301 Allen Road. Their passion for providing a world-class experience transitions to this upscale retreat located on the mezzanine level of the Peoria Civic Center.

For business or pleasure, consider the Lexus Club for your next event. The Lexus Club is the place to be for your company's upcoming party, business retreat or for your group of friends to have dinner before attending an event. It is also used in conjunction with all arena events and may not be available for private gatherings.

Our experienced event staff will assist with all of your planning needs and ensure you receive the personal attention you deserve. For more information please phone Jo Stowell (309) 680-3520 or e-mail jstowell@peoriaciviccenter.com.

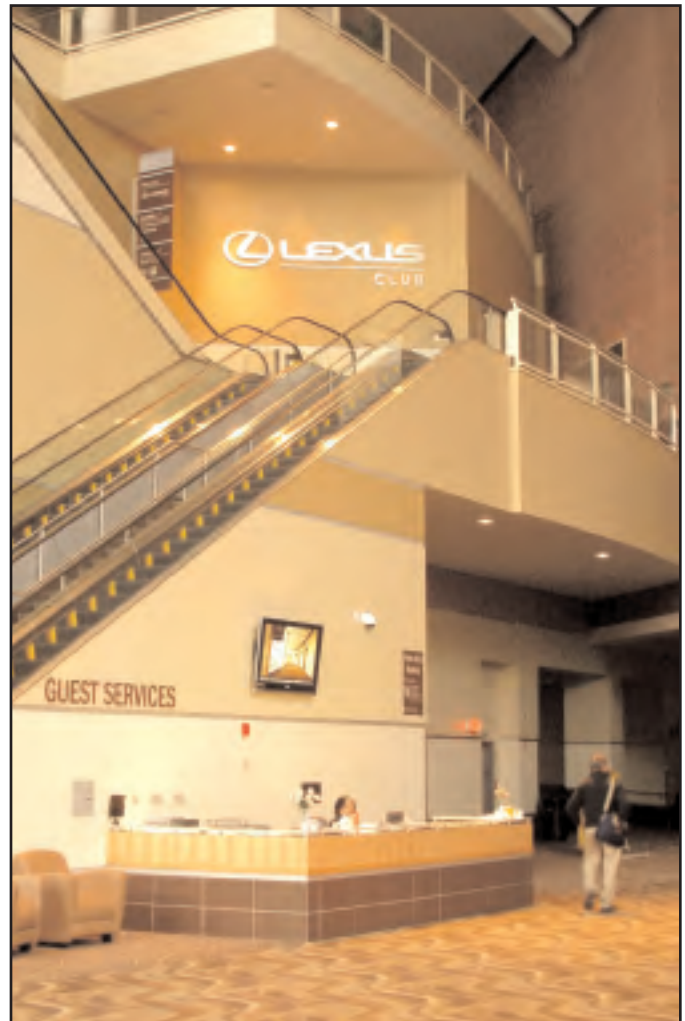

PEORIA CIVIC CENTER®

Peoria Civic Center
T 309.673.8900 F 309.673.9223
201 SW Jefferson Ave., Peoria, IL 61602
www.PeoriaCivicCenter.com



Street Level



Top Level

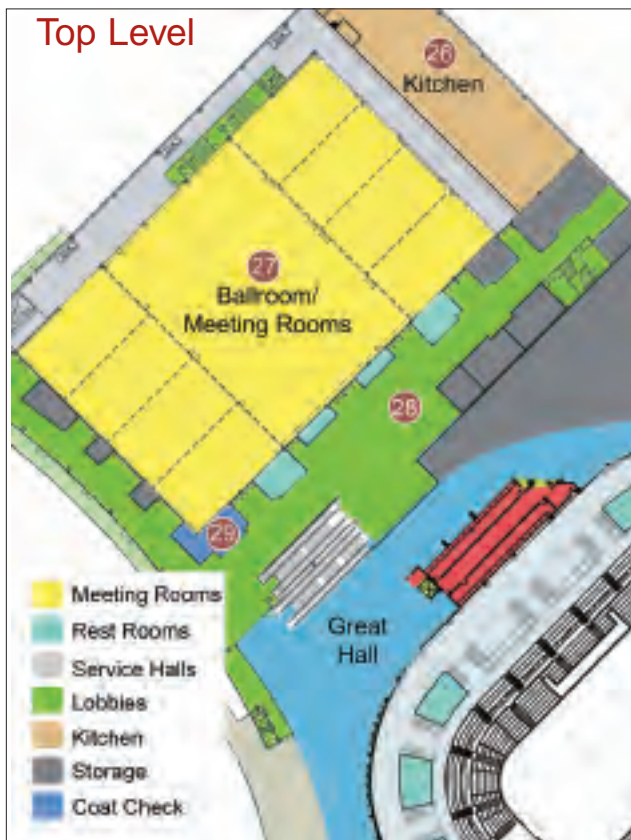

FINDING YOUR WAY

Street Level

- 1 Arena
- 2 Arena Entrance
- 3 Arena Entrance
- 4 Arena VIP Entrance
- 5 Great Hall Entrance
- 6 Peoria Rivermen Hockey Team Store
- 7 Box Office
- 8 Box Office Entrance
- 9 Great Hall
- 10 Marquee Parking Lot
- 11 Loading Docks
- 12 Exhibit Halls
- 13 Terrazzo Lobby
- 14 Terrazzo Entrance

- 15 Business Center

- 16 Meeting Rooms
- 17 Skylight Lobby
- 18 Monroe Theater Entrance
- 19 Fulton Parking Lot
- 20 Theater
- 21 Fulton Theater Entrance
- 22 Skylight Lobby Entrance
- 23 Triangle Lobby Entrance
- 24 Triangle Lobby
- 25 City Hall

Top Level

- 26 Kitchen
- 27 Ballroom / Meeting Rooms
- 28 Pre-function Space
- 29 Coat Check